

CURVE TABLE						
CURVE	LENGTH	RADIUS	TANGENT	CHORD	BEARING	DELTA
C20	442.12	463.00	239.54	425.51	S00°52'37"E	54°42'42"
C21	130.56	417.50	66.91	130.02	N80°28'42"W	17°56'01"
C22	242.62	453.00	124.30	239.73	N15°20'27"E	30°41'14"
C23	82.35	253.00	46.70	81.84	N10°43'04"W	20°54'55"
C24	275.77	300.00	149.12	267.06	S05°15'16"W	52°51'36"
C25	252.28	50.00	35.62	58.02	N73°25'49"E	289°04'24"
C26	328.23	427.00	190.42	347.82	N39°05'04"W	48°04'16"
C27	206.70	220.00	111.69	199.18	N48°02'01"E	53°49'56"
C28	189.51	427.00	96.34	187.96	N02°20'08"W	25°25'49"
C29	185.42	600.00	93.46	184.69	N85°56'51"E	25°25'49"
C30	104.25	290.00	52.89	103.49	N83°39'11"W	23°53'30"
C31	252.29	50.00	35.60	58.00	S24°23'22"E	289°05'56"
C32	81.88	250.00	41.38	81.61	S15°00'06"W	18°47'16"
C33	111.97	603.00	56.15	111.81	S05°03'34"W	10°38'22"
C34	141.23	800.00	70.94	140.90	S78°27'21"E	13°29'11"
C35	62.10	205.00	31.29	61.86	S11°53'30"E	17°21'22"
C36	53.55	205.00	26.93	53.39	N13°05'14"W	14°57'35"
C37	252.29	50.00	35.60	58.00	S88°47'11"W	289°05'56"
C38	88.63	300.00	44.64	88.31	S85°33'29"W	16°55'40"
C39	70.45	45.00	44.77	63.47	N44°48'45"E	89°42'04"
C40	252.29	50.00	35.60	58.00	N04°01'19"E	289°05'56"
C41	62.74	427.00	31.42	62.68	N67°19'40"W	06°25'05"
C42	164.63	180.00	88.58	158.55	N42°40'53"W	52°24'09"
C43	133.37	250.00	68.31	131.79	S36°24'01"W	30°33'57"
C44	164.95	180.00	88.78	159.24	N25°25'48"E	62°30'24"
C45	252.29	50.00	35.60	58.00	S89°10'36"W	289°05'56"
C46	168.58	317.50	86.32	166.59	N75°20'15"E	30°25'05"
C47	202.73	382.50	103.81	200.36	N75°18'43"E	30°22'02"

Exception to Plat

Lot 1  
Block 4

Reserve G

Lot 1  
Block 5

Reserve A

Block 1

Reserve E

Block 6

Reserve C

Block 2

LEGEND

- Utility Easement 20' U.E.
- Drainage Easement 20' Dr. E.
- Iron Set
- Building Setback 30' SB
- Curve Label C
- Line Label L
- Center Line CL
- Monument Found

NOTE:

This Addition is subject to the conditions of the Planned Unit Development PUD 2000-0001.

BENCHMARKS:

- NGVD Datum
- 1. Railroad spike in power pole, approximately 25' south and 30' east of W 1/4 Corner, Section 35-27-2E. Elevation 1349.65
- 2. Square on south hub guard of RCBC just west of NW Corner of Section 35-27-2E. Elevation 1311.90

LINE	LENGTH	BEARING
L14	58.68	S21°10'32"E
L15	92.74	S00°15'37"E
L16	100.71	S31°41'04"W
L17	255.28	N00°59'51"E
L18	106.30	N89°27'13"W
L19	85.04	S71°55'59"W
L20	46.22	N05°36'16"W
L21	257.23	S10°22'45"W
L22	90.71	N65°36'28"E
L23	64.53	N00°15'37"W
L24	117.83	S71°42'46"E
L25	57.73	N20°34'12"W
L26	65.45	N03°12'49"W
L27	108.75	S85°58'41"E
L28	89.87	N70°54'46"E
L29	182.27	N68°29'44"E
L30	399.67	S71°32'12"E
L31	69.13	N51°41'00"E
L32	39.62	S21°07'03"W
L33	74.82	N68°52'57"W
L34	46.99	S21°07'03"W
L35	35.99	N16°28'48"W
L36	84.85	S00°45'24"E
L37	8.74	S10°22'45"W
L38	323.08	N89°27'13"W
L39	28.43	S60°07'42"W
L40	376.56	N89°30'16"W

MINIMUM BUILDING ELEVATIONS		
Minimum Low Opening Elevation		
Location	NGVD Datum	City Datum
Lots 1-5, Blk 1	1316.0	128.6
Lots 6-19, Blk 1	1327.3	139.9
Lots 12-32, Blk 2	1326.4	139.0
Lots 1-9, Blk 6	1335.0	147.6
Lot 10, Blk 6	1335.0	147.6
Lots 21-26, Blk 6	1335.0	147.6

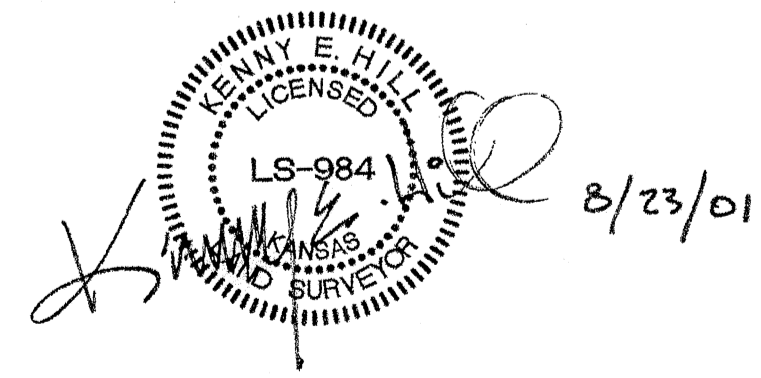

# EQUESTRIAN ESTATES

An Addition to Wichita - Sedgwick County, Kansas  
(Associated Zone Case PUD 2000-0001)